

Insulated cord end terminals, HI 2X type

FEATURES & BENEFITS

- thin-walled terminal Cu, for multi-wire flexible cables; possible crimping of two cables in one terminal
- insulating sleeve: enhances resistance to vibrations, mitigates short-circuit risk, facilitates cable installation
- insulation colours facilitate cross-section identification

APPLICATION

Designed to combine two multi-core conductors.

MECHANICAL DATA

Insulation	polypropylene
Material	Cu
Halogen-free	yes
Covering	tin-plated
Operating temperature [°C]	-30 ÷ +95

CERTIFICATES & STANDARDS

Design DIN 46228/4 (concerns only the copper part of terminal)

NOTE!

Other lengths and colours on request.

UL certificate - for up-to-date information, visit www.ergom.com

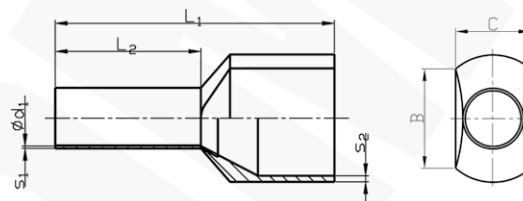

Type	Index Ergom	Cross-section [mm²]	AWG cross-section	L ₁	L ₂	d ₁	C x B	s ₁	s ₂	Insulation colour	Quantity in package [pcs]	Weight [kg]
HI 2X0,5/8 (500 PCS)	E08KH-02020100101	2x0,5	2x20	15,0	8	1,4	2,5x4,7	0,15	0,25	orange	500	0,04
HI 2X0,5/8 (100 PCS)	E08KH-02020103901	2x0,5	2x20	15,0	8	1,4	2,5x4,7	0,15	0,25	orange	100	0,01
HI 2X0,5/8 DIN (500 PCS)	E08KH-02020100201	2x0,5	2x20	15,0	8	1,4	2,5x4,7	0,15	0,25	white	500	0,04
HI 2X0,5/8 DIN (100 PCS)	E08KH-02020104001	2x0,5	2x20	15,0	8	1,4	2,5x4,7	0,15	0,25	white	100	0,01
HI 2X0,75/8 (500 PCS)	E08KH-02020100301	2x0,75	2x20	15,0	8	1,7	2,8x5	0,15	0,25	white	500	0,04
HI 2X0,75/8 (100 PCS)	E08KH-02020104121	2x0,75	2x20	15,0	8	1,7	2,8x5	0,15	0,25	white	100	0,01
HI 2X0,75/8 DIN (500 PCS)	E08KH-02020100501	2x0,75	2x20	15,0	8	1,7	2,8x5	0,15	0,25	grey	500	0,04
HI 2X0,75/8 DIN (100 PCS)	E08KH-02020104201	2x0,75	2x20	15,0	8	1,7	2,8x5	0,15	0,25	grey	100	0,01
HI 2X0,75/8 F (500 PCS)	E08KH-02020100701	2x0,75	2x20	15,0	8	1,7	2,8x5	0,15	0,25	blue	500	0,04
HI 2X0,75/8 F (100 PCS)	E08KH-02020104301	2x0,75	2x20	15,0	8	1,7	2,8x5	0,15	0,25	blue	100	0,01
HI 2X0,75/10 (500 PCS)	E08KH-02020100401	2x0,75	2x20	17,0	10	1,7	2,8x5	0,15	0,25	white	500	0,05
HI 2X0,75/10 (100 PCS)	E08KH-02020104401	2x0,75	2x20	17,0	10	1,7	2,8x5	0,15	0,25	white	100	0,01
HI 2X0,75/10 DIN (500 PCS)	E08KH-02020100601	2x0,75	2x20	17,0	10	1,7	2,8x5	0,15	0,25	grey	500	0,05
HI 2X0,75/10 DIN (100 PCS)	E08KH-02020104501	2x0,75	2x20	17,0	10	1,7	2,8x5	0,15	0,25	grey	100	0,01
HI 2X0,75/10 F (500 PCS)	E08KH-02020100801	2x0,75	2x20	17,0	10	1,7	2,8x5	0,15	0,25	blue	500	0,05
HI 2X0,75/10 F (100 PCS)	E08KH-02020104601	2x0,75	2x20	17,0	10	1,7	2,8x5	0,15	0,25	blue	100	0,01
HI 2X1/8 (500 PCS)	E08KH-02020100901	2x1	2x18	15,0	8	1,95	3,4x5,4	0,15	0,30	yellow	500	0,05
HI 2X1/8 (100 PCS)	E08KH-02020104721	2x1	2x18	15,0	8	1,95	3,4x5,4	0,15	0,30	yellow	100	0,01
HI 2X1/8 DIN (500 PCS)	E08KH-02020101101	2x1	2x18	15,0	8	1,95	3,4x5,4	0,15	0,30	red	500	0,05
HI 2X1/8 DIN (100 PCS)	E08KH-02020104801	2x1	2x18	15,0	8	1,95	3,4x5,4	0,15	0,30	red	100	0,01
HI 2X1/10 (500 PCS)	E08KH-02020101001	2x1	2x18	17,0	10	1,95	3,4x5,4	0,15	0,30	yellow	500	0,06
HI 2X1/10 (100 PCS)	E08KH-02020104921	2x1	2x18	17,0	10	1,95	3,4x5,4	0,15	0,30	yellow	100	0,01
HI 2X1/10 DIN (500 PCS)	E08KH-02020101201	2x1	2x18	17,0	10	1,95	3,4x5,4	0,15	0,30	red	500	0,06
HI 2X1/10 DIN (100 PCS)	E08KH-02020105001	2x1	2x18	17,0	10	1,95	3,4x5,4	0,15	0,30	red	100	0,01
HI 2X1,5/8 (500 PCS)	E08KH-02020101301	2x1,5	2x16	16,0	8	2,2	3,6x6,6	0,15	0,30	red	500	0,06
HI 2X1,5/8 (100 PCS)	E08KH-02020105121	2x1,5	2x16	16,0	8	2,2	3,6x6,6	0,15	0,30	red	100	0,02
HI 2X1,5/8 DIN (500 PCS)	E08KH-02020101501	2x1,5	2x16	16,0	8	2,2	3,6x6,6	0,15	0,30	black	500	0,06

Type	Index Ergom	Cross-section [mm ²]	AWG cross-section	L ₁	L ₂	d ₁	C x B	s ₁	s ₂	Insulation colour	Quantity in package [pcs]	Weight [kg]
HI 2X1,5/8 DIN (100 PCS)	E08KH-02020105201	2x1,5	2x16	16,0	8	2,2	3,6x6,6	0,15	0,30	black	100	0,02
HI 2X1,5/12 (500 PCS)	E08KH-02020101401	2x1,5	2x16	20,0	12	2,2	3,6x6,6	0,15	0,30	red	500	0,06
HI 2X1,5/12 (100 PCS)	E08KH-02020105301	2x1,5	2x16	20,0	12	2,2	3,6x6,6	0,15	0,30	red	100	0,02
HI 2X1,5/12 DIN (500 PCS)	E08KH-02020101601	2x1,5	2x16	20,0	12	2,2	3,6x6,6	0,15	0,30	black	500	0,06
HI 2X1,5/12 DIN (100 PCS)	E08KH-02020105401	2x1,5	2x16	20,0	12	2,2	3,6x6,6	0,15	0,30	black	100	0,02
HI 2X2,5/10 (500 PCS)	E08KH-02020101701	2x2,5	2x14	18,5	10	2,8	4,2x7,8	0,20	0,30	blue	500	0,08
HI 2X2,5/10 (100 PCS)	E08KH-02020105521	2x2,5	2x14	18,5	10	2,8	4,2x7,8	0,20	0,30	blue	100	0,02
HI 2X2,5/10 F (500 PCS)	E08KH-02020101901	2x2,5	2x14	18,5	10	2,8	4,2x7,8	0,20	0,30	grey	500	0,08
HI 2X2,5/10 F (100 PCS)	E08KH-02020105601	2x2,5	2x14	18,5	10	2,8	4,2x7,8	0,20	0,30	grey	100	0,02
HI 2X2,5/13 (500 PCS)	E08KH-02020101801	2x2,5	2x14	21,5	13	2,8	4,2x7,8	0,20	0,30	blue	500	0,08
HI 2X2,5/13 (100 PCS)	E08KH-02020105701	2x2,5	2x14	21,5	13	2,8	4,2x7,8	0,20	0,30	blue	100	0,02
HI 2X2,5/13 F (500 PCS)	E08KH-02020102001	2x2,5	2x14	21,5	13	2,8	4,2x7,8	0,20	0,30	grey	500	0,08
HI 2X2,5/13 F (100 PCS)	E08KH-02020105801	2x2,5	2x14	21,5	13	2,8	4,2x7,8	0,20	0,30	grey	100	0,02
HI 2X4/12 (100 PCS)	E08KH-02020102101	2x4	2x12	23,0	12	3,7	4,9x8,9	0,20	0,40	grey	100	0,03
HI 2X4/12 F (100 PCS)	E08KH-02020102201	2x4	2x12	23,0	12	3,7	4,9x8,9	0,20	0,40	orange	100	0,03
HI 2X6/14 (100 PCS)	E08KH-02020102301	2x6	2x10	26,0	14	4,8	6,9x10,0	0,20	0,40	black	100	0,05
HI 2X6/14 DIN (100 PCS)	E08KH-02020102401	2x6	2x10	26,0	14	4,8	6,9x10,0	0,20	0,40	yellow	100	0,05
HI 2X6/14 F (100 PCS)	E08KH-02020102501	2x6	2x10	26,0	14	4,8	6,9x10,0	0,20	0,40	green	100	0,05
HI 2X10/14 (100 PCS)	E08KH-02020102601	2x10	2x8	26,0	14	6,4	7,2x13	0,20	0,40	ivory	100	0,06
HI 2X10/14 DIN (100 PCS)	E08KH-02020102701	2x10	2x8	26,0	14	6,4	7,2x13	0,20	0,40	red	100	0,06
HI 2X10/14 F (100 PCS)	E08KH-02020102801	2x10	2x8	26,0	14	6,4	7,2x13	0,20	0,40	brown	100	0,06
HI 2X16/14 (50 PCS)	E08KH-02020102901	2x16	2x6	30,0	14	8,2	9,6x18,4	0,20	0,40	green	50	0,04
HI 2X16/14 DIN (50 PCS)	E08KH-02020103001	2x16	2x6	30,0	14	8,2	9,6x18,4	0,20	0,40	blue	50	0,04
HI 2X16/14 F (50 PCS)	E08KH-02020103101	2x16	2x6	30,0	14	8,2	9,6x18,4	0,20	0,40	ivory	50	0,04