

Aluminium terminals, KDA type

FEATURES & BENEFITS

- ring terminal Al, crimped part as per DIN, without galvanic tin plating
- description of cable cross-section, terminal size and crimping die number on crimped part surface

MECHANICAL DATA

Material	Al
Surface	uncoated

CERTIFICATES & STANDARDS

Standards	EN IEC 61238-1-1:2019 EN IEC 61238-1-3:2019 - mechanical strength Class 1 - short-circuit resistance Class A for range of rated cross-section 16-300mm ²
Design	DIN 46329 – concerns only the tubular part

NOTE!

- terminals are filled with special contact grease, packed in a separate foil bag;
- sector-shaped conductors must be rounded with special dies.

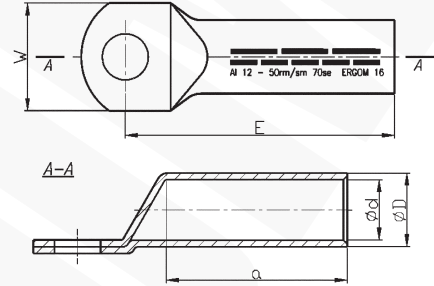

Type	Index Ergom	Cross-section, re/se [mm ²]	Cross-section, rm/sm [mm ²]	d	D	a	E	W	Screw hole	Socket code no.	Lz/s	Lz/w	Quantity in package [pcs]	Weight [kg]									
KDA 16/6 (100 PCS)	E12KA-01030100100	25	16	5,6	12,0	30	50	18	M6	12	2	4	100	1,55									
KDA 16/6 (10 PCS)	E12KA-01030100102								10				0,16										
KDA 16/8 (100 PCS)	E12KA-01030100200								100				1,5										
KDA 16/8 (10 PCS)	E12KA-01030100202								10				0,15										
KDA 16/10 (100 PCS)	E12KA-01030100300								100				1,6										
KDA 16/10 (10 PCS)	E12KA-01030100302								10				0,16										
KDA 25/6 (100 PCS)	E12KA-01030100400								35				25	6,8	12,0	30	57	M6	12	2	4	100	1,5
KDA 25/6 (10 PCS)	E12KA-01030100402																	10				0,15	
KDA 25/8 (100 PCS)	E12KA-01030100500																	100				1,5	
KDA 25/8 (10 PCS)	E12KA-01030100502																	10				0,15	
KDA 25/10 (100 PCS)	E12KA-01030100600	100	1,6																				
KDA 25/10 (10 PCS)	E12KA-01030100602	10	0,16																				
KDA 25/12 (100 PCS)	E12KA-01030100700	100	1,55																				
KDA 25/12 (10 PCS)	E12KA-01030100702	10	0,16																				
KDA 35/6 (100 PCS)	E12KA-01030100800	50	35	8,0	14,0	42	68	M6		14	3	5						100				2,3	
KDA 35/6 (10 PCS)	E12KA-01030100802							10										0,23					
KDA 35/8 (100 PCS)	E12KA-01030100900							100	2,2														
KDA 35/8 (10 PCS)	E12KA-01030100902							10	0,22														
KDA 35/10 (100 PCS)	E12KA-01030101000							100	2,2														
KDA 35/10 (10 PCS)	E12KA-01030101002							10	0,22														
KDA 35/12 (100 PCS)	E12KA-01030101100							100	2,4														
KDA 35/12 (10 PCS)	E12KA-01030101102							10	0,24														
KDA 35/14 (100 PCS)	E12KA-01030101200							100	2,4														
KDA 35/14 (10 PCS)	E12KA-01030101202							10	0,24														

Type	Index Ergom	Cross-section, re/se [mm ²]	Cross-section, rm/sm [mm ²]	d	D	a	E	W	Screw hole	Socket code no.	Lz/s	Lz/w	Quantity in package [pcs]	Weight [kg]										
KDA 50/8 (100 PCS)	E12KA-01030101300	70	50	9,8	16,0	42	69		M8	16	3	5	100	2,9										
KDA 50/8 (10 PCS)	E12KA-01030101302								10				0,29											
KDA 50/10 (100 PCS)	E12KA-01030101400								100				3											
KDA 50/10 (10 PCS)	E12KA-01030101402								10				0,3											
KDA 50/12 (100 PCS)	E12KA-01030101500								100				2,9											
KDA 50/12 (10 PCS)	E12KA-01030101502								10				0,29											
KDA 50/14 (100 PCS)	E12KA-01030101600								100				2,9											
KDA 50/14 (10 PCS)	E12KA-01030101602								10				0,29											
KDA 70/8 (100 PCS)	E12KA-01030101700								95				70	11,2	18,5	52	79		M8	18	3	6	100	3,8
KDA 70/8 (10 PCS)	E12KA-01030101702																		10				0,38	
KDA 70/10 (100 PCS)	E12KA-01030101800																		100				4,5	
KDA 70/10 (10 PCS)	E12KA-01030101802																		10				0,45	
KDA 70/12 (100 PCS)	E12KA-01030101900																		100				4,5	
KDA 70/12 (10 PCS)	E12KA-01030101902																		10				0,45	
KDA 70/14 (100 PCS)	E12KA-01030102000																		100				4,3	
KDA 70/14 (10 PCS)	E12KA-01030102002																		10				0,43	
KDA 70/16 (100 PCS)	E12KA-01030102100	100	4,3																					
KDA 70/16 (10 PCS)	E12KA-01030102102	10	0,43																					
KDA 95/10 (50 PCS)	E12KA-01030102200	120	95	13,2	22,0	56	82			M10	22	3							6				50	3,6
KDA 95/10 (10 PCS)	E12KA-01030102202									10													0,72	
KDA 95/12 (50 PCS)	E12KA-01030102300									50													3,6	
KDA 95/12 (10 PCS)	E12KA-01030102302									10													0,72	
KDA 95/14 (50 PCS)	E12KA-01030102400									50													3,3	
KDA 95/14 (10 PCS)	E12KA-01030102402									10													0,66	
KDA 95/16 (50 PCS)	E12KA-01030102500								50	3,7														
KDA 95/16 (10 PCS)	E12KA-01030102502								10	0,74														
KDA 120/10 (50 PCS)	E12KA-01030102600								150	120			14,7	23,0	56	85		M10		22	3	6	50	3,6
KDA 120/10 (10 PCS)	E12KA-01030102602																	10					0,72	
KDA 120/12 (50 PCS)	E12KA-01030102700																	50					4,4	
KDA 120/12 (10 PCS)	E12KA-01030102702																	10					0,88	
KDA 120/14 (50 PCS)	E12KA-01030102800																	50					4,75	
KDA 120/14 (10 PCS)	E12KA-01030102802																	10					0,95	
KDA 120/16 (50 PCS)	E12KA-01030102900																	50					3,63	
KDA 120/16 (10 PCS)	E12KA-01030102902																	10					0,73	
KDA 150/10 (50 PCS)	E12KA-01030103000	185	150	16,3	25,0	60	91				M10	25						3	6				50	4,55
KDA 150/10 (10 PCS)	E12KA-01030103002										10												0,91	
KDA 150/12 (50 PCS)	E12KA-01030103100										50												4,5	
KDA 150/12 (10 PCS)	E12KA-01030103102										10												0,9	
KDA 150/14 (50 PCS)	E12KA-01030103200										50												4,62	
KDA 150/14 (10 PCS)	E12KA-01030103202										10												0,93	
KDA 150/16 (50 PCS)	E12KA-01030103300										50												4,5	
KDA 150/16 (10 PCS)	E12KA-01030103302										10												0,9	
KDA 150/20 (50 PCS)	E12KA-01030103400								240	185	18,3		28,5	60	99		M10			28	3	6	50	4,65
KDA 150/20 (10 PCS)	E12KA-01030103402																10						0,93	
KDA 185/12 (50 PCS)	E12KA-01030103500																50						5,8	
KDA 185/12 (10 PCS)	E12KA-01030103502																10						1,16	
KDA 185/14 (50 PCS)	E12KA-01030103600																50						6,2	
KDA 185/14 (10 PCS)	E12KA-01030103602																10						1,24	
KDA 185/16 (50 PCS)	E12KA-01030103700																50						6,3	
KDA 185/16 (10 PCS)	E12KA-01030103702																10						1,26	
KDA 185/20 (50 PCS)	E12KA-01030103800	50	6,4																					
KDA 185/20 (10 PCS)	E12KA-01030103802	10	1,28																					
KDA 240/12 (50 PCS)	E12KA-01030103900	300	240	21,0	32,0	70	102					M12					32	3	8				50	8
KDA 240/12 (10 PCS)	E12KA-01030103902											10											1,6	
KDA 240/14 (50 PCS)	E12KA-01030104000											50											8,2	
KDA 240/14 (10 PCS)	E12KA-01030104002											10											1,64	
KDA 240/16 (50 PCS)	E12KA-01030104100											50											7,3	
KDA 240/16 (10 PCS)	E12KA-01030104102											10											1,46	
KDA 240/20 (50 PCS)	E12KA-01030104200								50	8,6														
KDA 240/20 (10 PCS)	E12KA-01030104202								10	1,72														

Type	Index Ergom	Cross-section, re/se [mm²]	Cross-section, rm/sm [mm²]	d	D	a	E	W	Screw hole	Socket code no.	Lz/s	Lz/w	Quantity in package [pcs]	Weight [kg]											
KDA 300/10 (25 PCS)	E12KA-01030104400	-	300	23,3	34,0	70	120	50	M12	34	3	8	25	4,5											
KDA 300/10 (10 PCS)	E12KA-01030104402												10	1,8											
KDA 300/12 (25 PCS)	E12KA-01030104300												25	4,5											
KDA 300/12 (10 PCS)	E12KA-01030104302												10	1,8											
KDA 300/14 (25 PCS)	E12KA-01030104500												25	4,5											
KDA 300/14 (10 PCS)	E12KA-01030104502												10	1,8											
KDA 300/16 (25 PCS)	E12KA-01030104600												25	4,5											
KDA 300/16 (10 PCS)	E12KA-01030104602												10	1,8											
KDA 300/20 (25 PCS)	E12KA-01030104700												25	4,2											
KDA 300/20 (10 PCS)	E12KA-01030104702												10	1,68											
KDA 400/14	E12KA-01030104802												-	400	26,0	38,5	100	165	60	M14	38	4	-	1	0,31
KDA 400/16	E12KA-01030104902																			M16				0,28	
KDA 400/20	E12KA-01030105002																			M20					
KDA 500/14	E12KA-01030105102												-	500	29,0	44,0	120	185	63	M14	44	4	-	1	0,51
KDA 500/16	E12KA-01030105202	M16																							
KDA 500/20	E12KA-01030105302	M20																							

Lz/s - Number of crimping - wide, Lz/w - Number of crimping - narrow